

”A quality washbasin for private homes and institutions”



ROPOX STANDARDLINE

WHEN YOU WANT A HEIGHT-ADJUSTABLE WASHBASIN THAT WILL LAST FOR YEARS

The StandardLine is an excellent choice if you are looking for a functional quality washbasin, that is suitable for both private homes, institutions and hospitals.

The height is adjusted electrically, and you can decide if the control switch should be placed on the right or left side of the washbasin. That is one of the small details that can make the basin fit your individual needs in the best possible way.

There are three types of washbasins to choose from so you can be sure to get the model that fit the users best:

- Standard: A simple and stylish washbasin for users without any special needs
- Support: A washbasin with good access and integrated handles that increases safety for users with limited physical capacity
- Hospital: Porcelain washbasin with an inwardly curved front for hospitals

No matter which StandardLine model you choose, you can be sure to get a washbasin that will last for years and is easy to clean as well.



VARIANT/MODEL

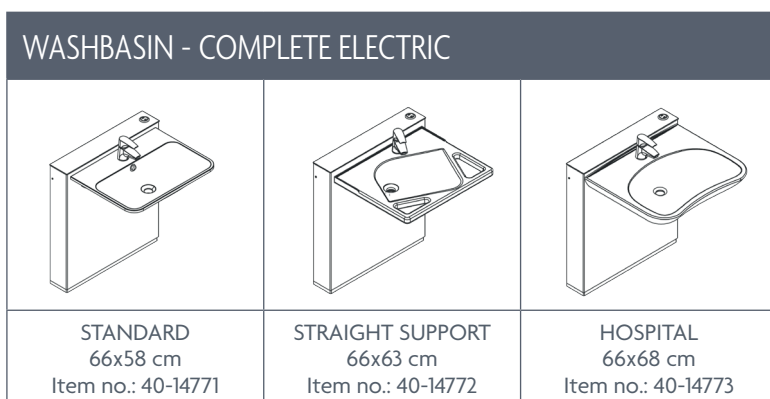
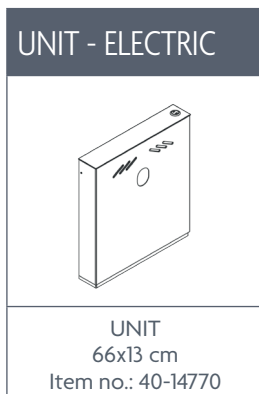

Available with or without wash basin.
Mixer tap and plumbing kit is included with the washbasins.

ACCESSORIES

Plumbing kit
Item no.: 40-14776

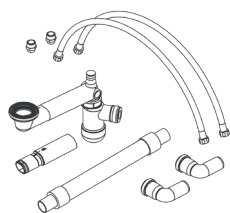

Wireless hand control, IR
Item no.: 30-72002



Plug with overflow
Item no.: 40-40935

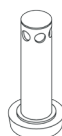

NB! More information about measurements, technical data, installation interfaces and much more under the product and in the instruction manuals on our website.