



# Installation interfaces

ROPOX KITCHEN PRODUCTS

# Contents

---

- CONTENTS ..... 2
- ROPOX DIAGONAL ..... 3
- ROPOX VERTI ELECTRIC ..... 4
- ROPOX VERTI-INSIDE ..... 7
- ROPOX BRACKETS ..... 8
- ROPOX BRACKETS ..... 9
- ROPOX FLEXIBASIC..... 10
- ROPOX FLEXIBASIC..... 11
- ROPOX FLEXIMANUAL ..... 12
- ROPOX FLEXIMANUAL ..... 13
- ROPOX FLEXIELECTRIC..... 14
- ROPOX FLEXIELECTRIC..... 15
- ROPOX FLEXICORNER ..... 16
- ROPOX FLEXIPLUS - 2 LEGS ..... 17
- ROPOX FLEXIPLUS - 3 LEGS ..... 18
- ROPOX FLEXIPLUSCORNER..... 19

# Ropox Diagonal

**Cabinet width 40-180 cm / 15,7 – 70,8 in (30-40904 to 30-40918)**



**Assumptions for schematic diagram:**

Cabinet height = **704 mm / 27,7 in** – (for other cabinet heights the dimension sketch will be changed accordingly)

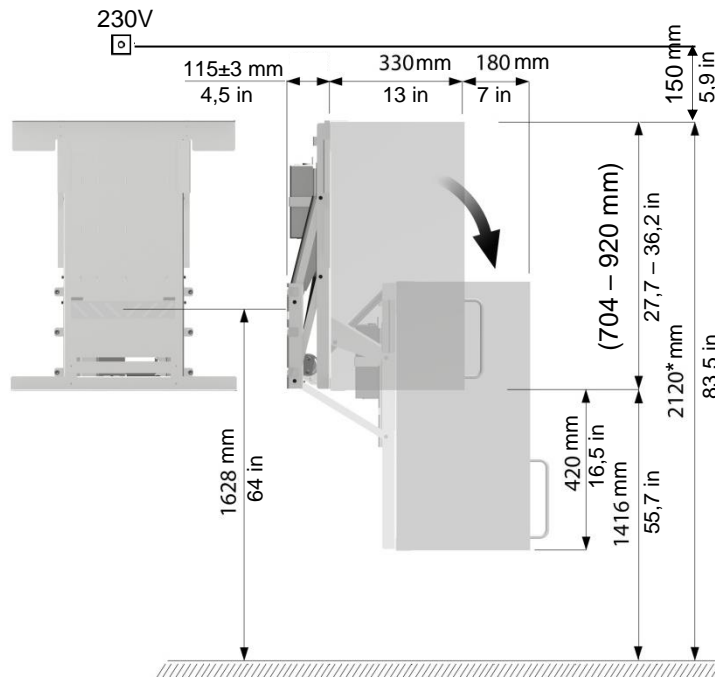

(The frame is designed for cabinet heights from 704-920 mm / 27,7-36,2 in.)

Height upper edge of wall cabinet = **2120 mm / 83,5 in** (for other cabinet heights the dimension sketch will be changed accordingly)



\* For cabinet height 704 mm / 27,7 in

**Construction – see dimensions on the following page**

-  Minimum area for reinforcement of wall. Wall material must be suitable for screw mounting.
-  Area for electric installation.
-  Area for conduit.

Cable for operation must be laid from the cabinet to the front edge of the worktop for mounting the control switch. We recommend the installation of a conduit in the wall to accommodate the cable (ø3.5cm).

If a high cabinet stands in the immediate vicinity of the Diagonal, the cable may be run through the cabinet to avoid the conduit in the wall.

**40 – 120 cm / 15,7 – 47,2 in**

Max. load 120kg/264lb evenly distributed, according to DS/EN 12182, based on 9 screws/bolts.

**130 – 180 cm / 51,2 – 70,8 in**

Max. load 220kg/485lb evenly distributed, according to DS/EN 12182, based on 18 screws/bolts.

**Minimum load capacity per screw/bolt:**

60kg/132lb

The fitter should always consider the material, condition and strength of the wall and use screws and rawlplugs suitable for the specific wall type.

**Cabinet width 40-50 cm**  
**15,7 – 19,7 in**  
**(30-40904 to 30-40905)**

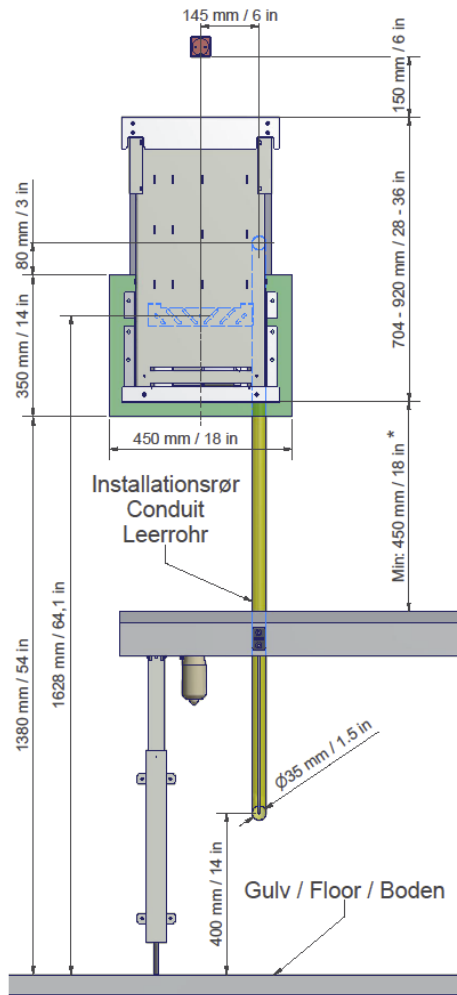

**Cabinet width 60-120 cm**  
**23,6 – 47,2 in**  
**(30-40906 to 30-40912)**

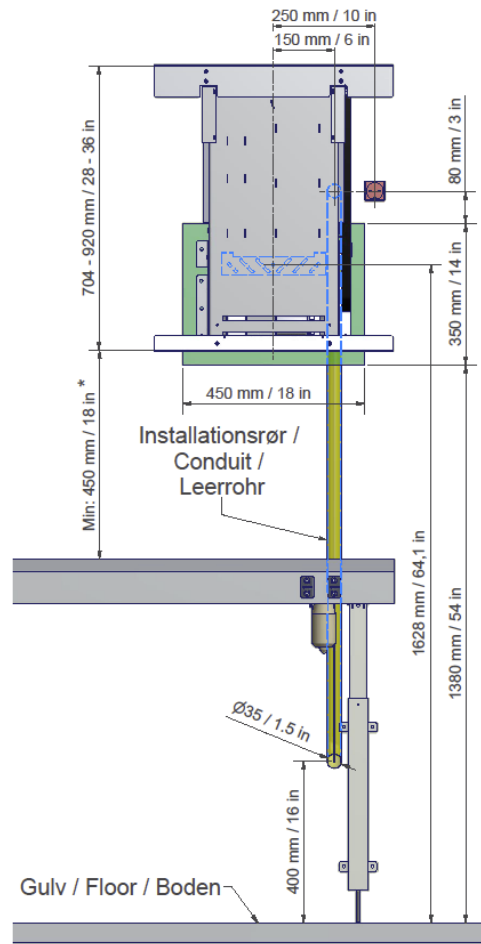

**Cabinet width 130-180 cm**  
**51,2 – 70,8 in**  
**(30-40913 to 30-40918)**

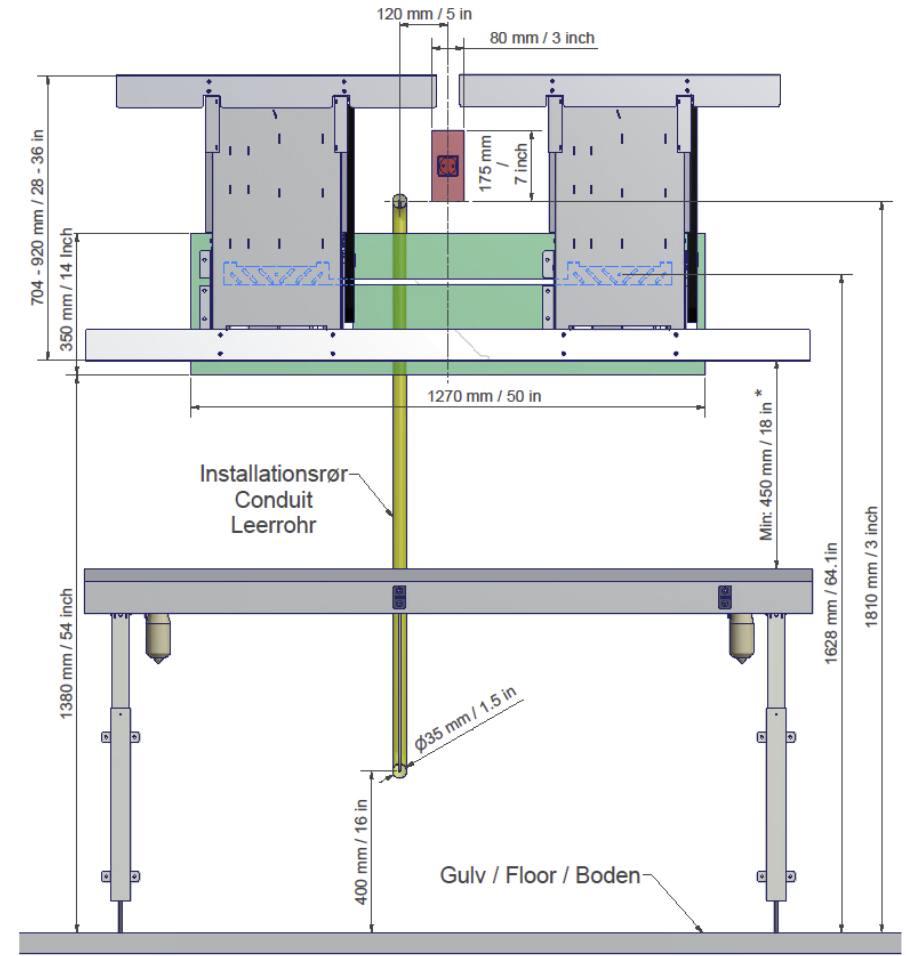

# Ropox Verti Electric

**Cabinet width 40-180 cm / 15,7 – 70,8 in (30-40604 to 30-40618)**





**Assumptions for schematic diagram:**

Cabinet height = **704 mm / 27,7 in** – (for other cabinet heights the dimension sketch will be changed accordingly)

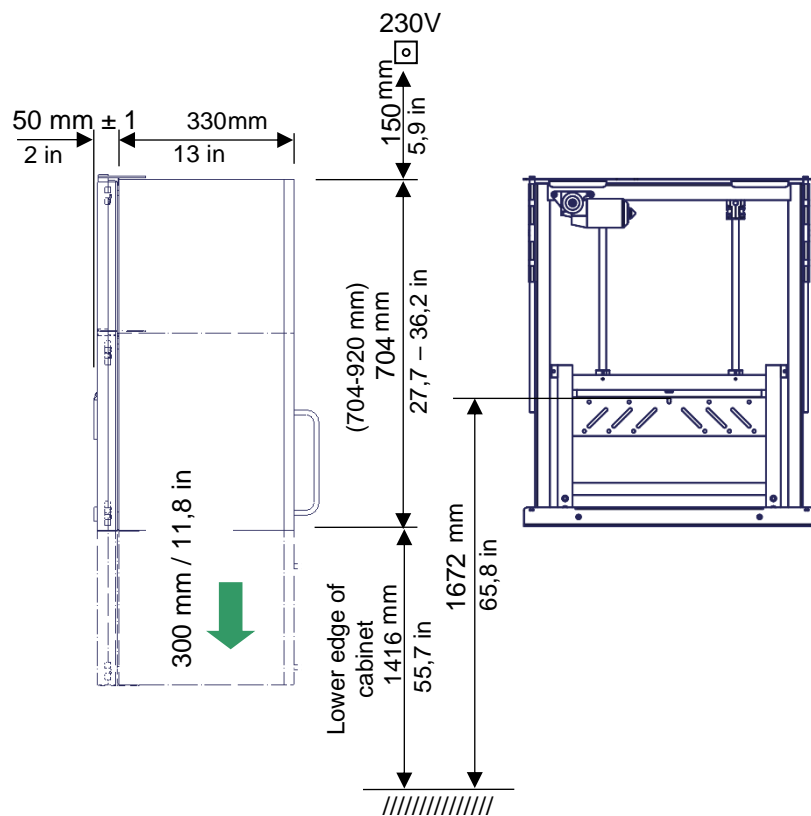
(The frame is designed for cabinet heights from 704-920 mm / 27,7-36,2 in.)



**Construction – see dimensions on the following page**

-  Minimum area for reinforcement of wall. Wall material must be suitable for screw mounting.
-  Area for electric installation.
-  Area for conduit.

Cable for operation must be laid from the cabinet to the front edge of the worktop for mounting of the control switch. We recommend the installation of an empty pipe conduit in the wall to accommodate the cable (ø3.5cm).

If a high cabinet stands in the immediate vicinity of the Verti Electric, the cable may be run through the cabinet to avoid the conduit in the wall.

**40 – 120 cm / 15,7 – 47,2 in**

Max. load 80kg/176lb evenly distributed, according to DS/EN 12182, based on 11 screws/bolts.

**130 – 180 cm / 51,2 – 70,8 in**

Max. load 120kg/264lb evenly distributed, according to DS/EN 12182, based on 22 screws/bolts.

**Minimum load capacity per screw/bolt:**

22.5kg/49lb

The fitter should always consider the material, condition and strength of the wall and use screws and rawplugs suitable for the specific wall type.

**Motor is placed inside the cabinet:**

For double unit 130-180 cm / 51,2 – 70,8 in, it is not possible to mount cabinet sizes smaller than 60 cm / 23,6 in on the right side, due to motor placement inside the cabinet.

**Cabinet width 40-50 cm  
15,7 – 19,7 in  
(30-40604 to 30-40605)**

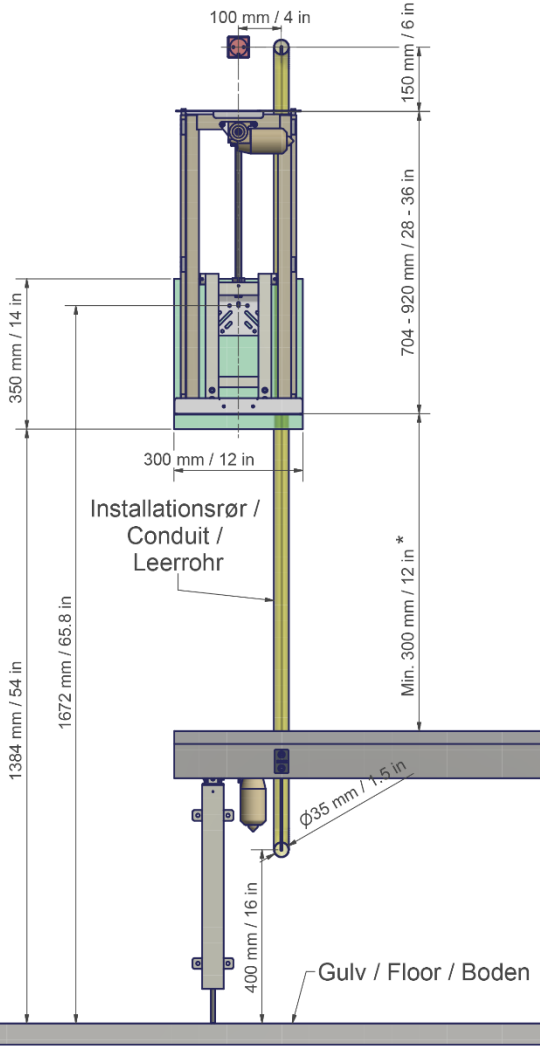

**Cabinet width 60-120 cm  
23,6 – 47,2 in  
(30-40606 to 30-40612)**

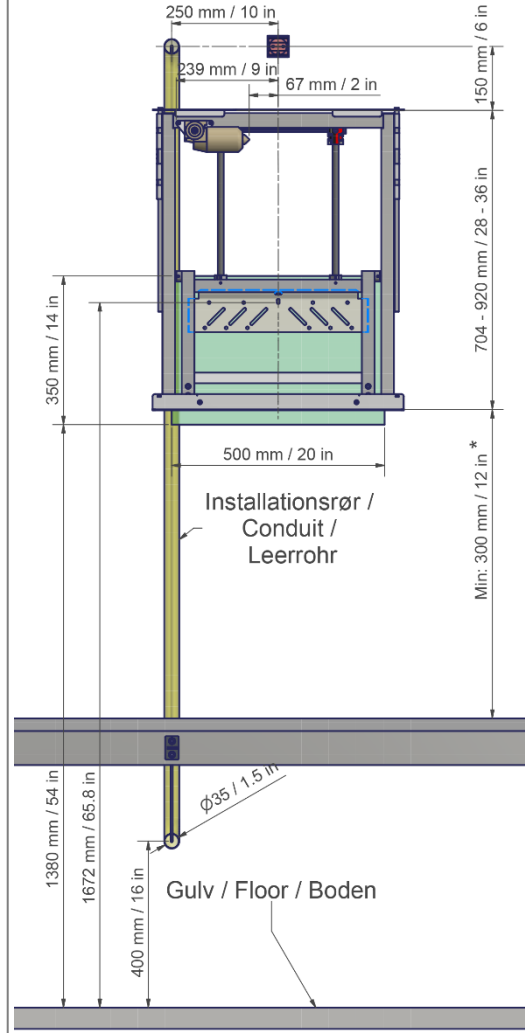

**Cabinet width 130-180 cm  
51,2 – 70,8 in  
(30-40613 to 30-40618)**

L	Part no.	L1
VertiElectric 130	30-40613	200 mm / 8 in
VertiElectric 140	30-40614	300 mm / 12 in
VertiElectric 150	30-40615	400 mm / 16 in
VertiElectric 160	30-40616	500 mm / 20 in
VertiElectric 170	30-40617	600 mm / 24 in
VertiElectric 180	30-40618	700 mm / 28 in

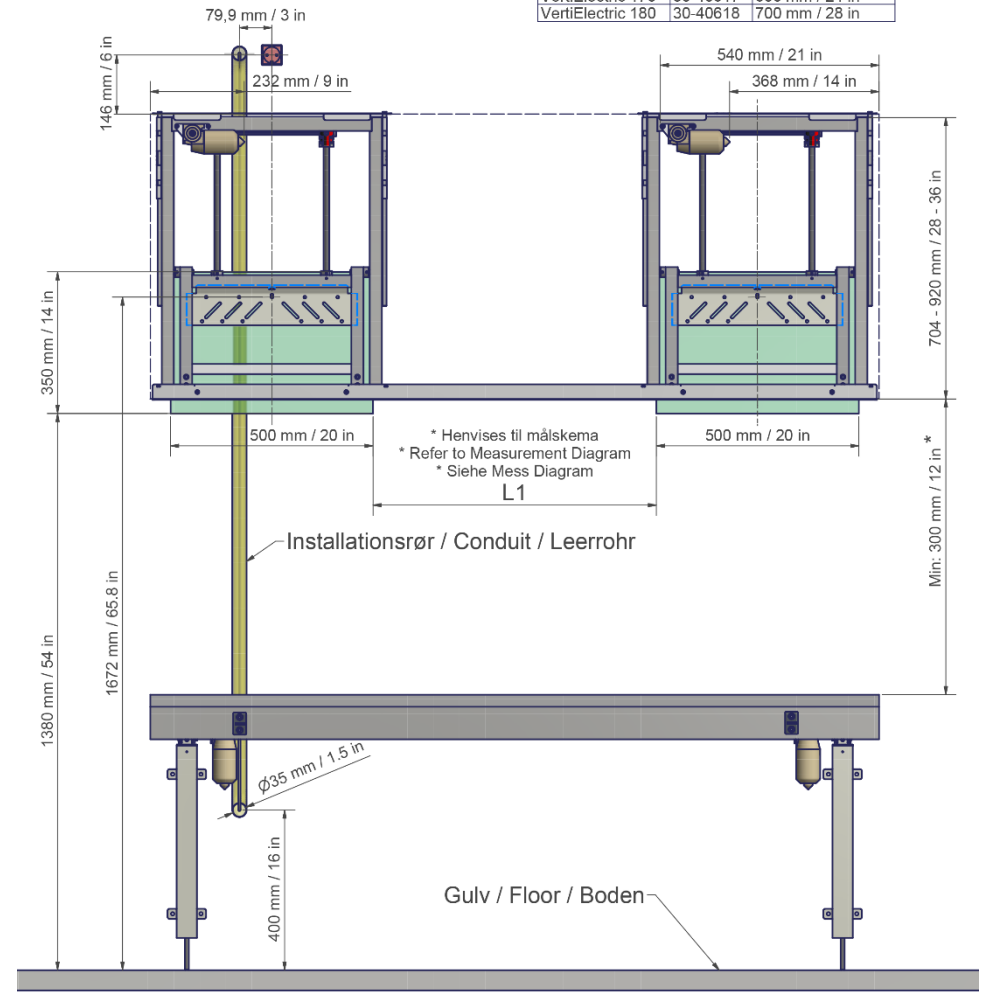

# Ropox Verti-Inside

**Cabinet depth 26.5cm/10,2in or 31cm/12,2in and cabinet width 40-100cm / 15,7 – 39,3 in (30-40404 to 30-40420)**

**Construction – see dimensions on the following page**

- Minimum area for reinforcement of wall. Wall material must be suitable for screw mounting.
- Area for electric installation.
- Area for conduit.

Cabinet height of 70.4cm/27,6in or more. For cabinet heights above 70.4cm/27,6in a fixed shelf is placed in the upper part of the cabinet (see illustration).

Cable for operation must be laid from the cabinet to the front edge of the worktop for mounting of the control switch. We recommend the installation of an empty conduit in the wall to accommodate the cable (ø3.5cm).

If a high cabinet stands in the immediate vicinity of Verti-Inside, the cable may be run through the cabinet to avoid the conduit in the wall.

Max. load 176kg evenly distributed over all three shelves for cabinets up to 100cm/39,3in in width, according to DS/EN 12182, based on 8 screws/bolts.

## Minimum load capacity per screw/bolt:

10.5kg/23lb

The fitter should always consider the material, condition and strength of the wall and use screws and rawplugs suitable for the specific wall type.

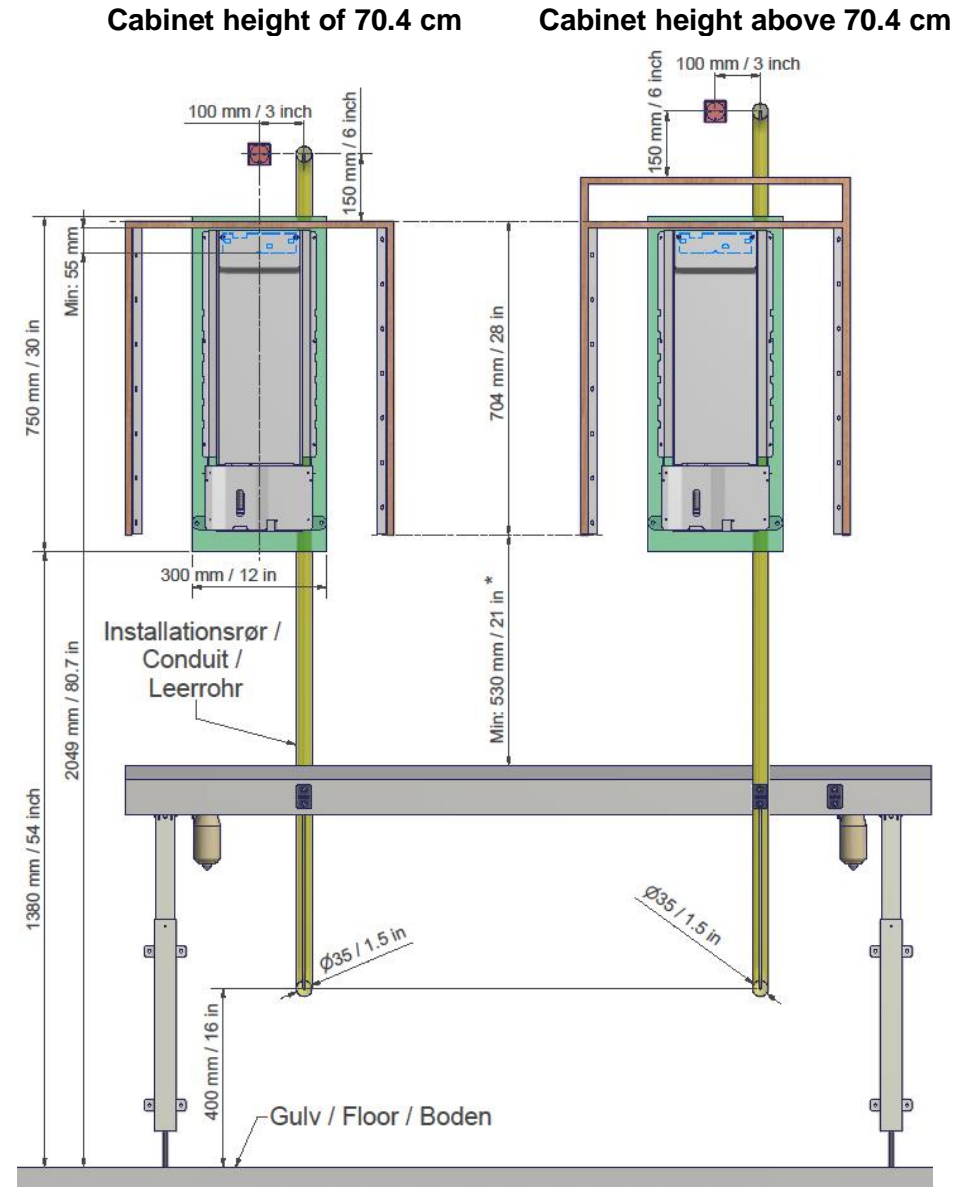

# Ropox Brackets

**For wall cabinets  
(30-80000)**

**Construction – see dimensions on the following page**

 Minimum area for reinforcement of wall. Wall material must be suitable for screw mounting.

Max. load 90kg evenly distributed over the cabinet up to 80cm/31,5in in width, according to DS/EN 12182, based on 12 screws/bolts.

**Minimum load capacity per screw/bolt:**  
25kg/55lb

The fitter should always consider the material, condition and strength of the wall and use screws and rawplugs suitable for the specific wall type.

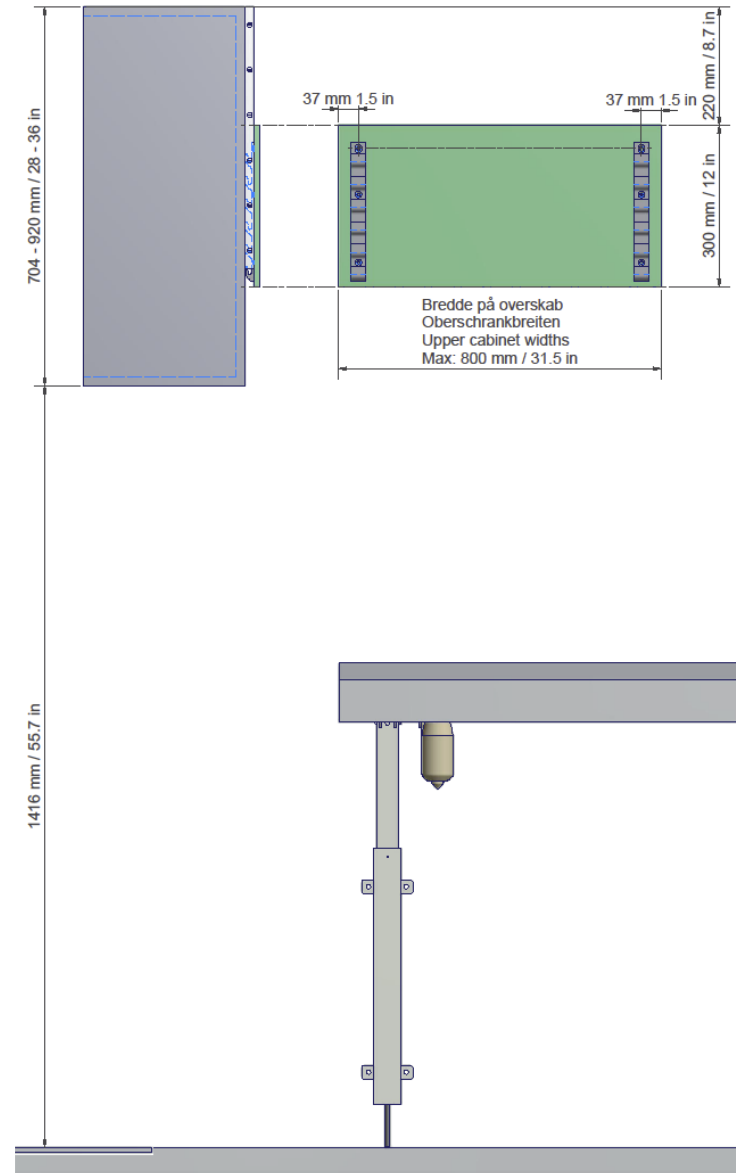





# Ropox Brackets

## For worktops (30-80006)

Construction – see dimensions on the following page

 Minimum area for reinforcement of wall. Wall material must be suitable for screw mounting.

 Area for electric and plumbing installations.

Max. load 75kg/165lb evenly distributed up to 80cm/31,5in in width, according to DS/EN 12182.

### Minimum load capacity per screw/bolt:

100 kg/220 lb

The fitter should always consider the material, condition and strength of the wall and use screws and rawplugs for the specific wall type.

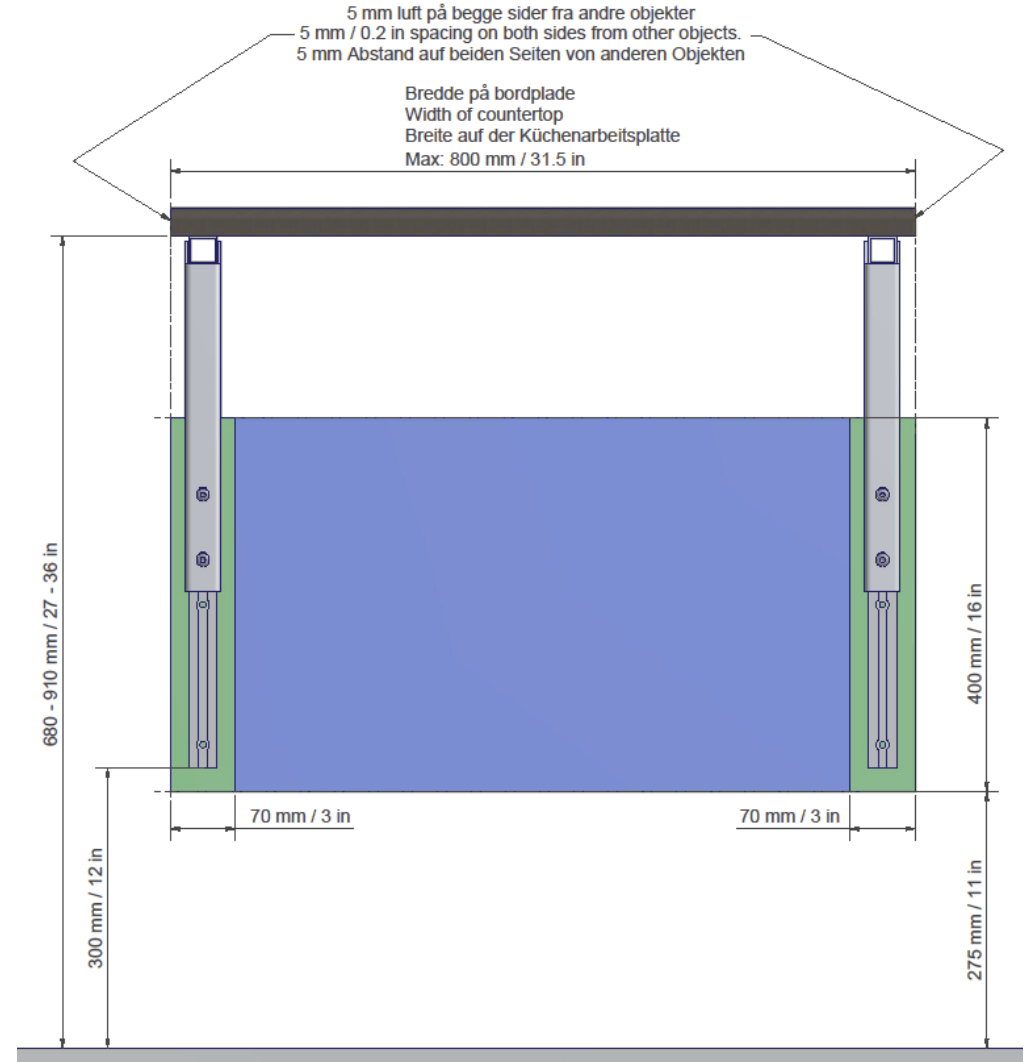

# Ropox FlexiBasic

600 - 2000 mm / 23,6 – 78,7 in  
(30-63060 - 30-63200)

Construction – see dimensions on the following page.

 Minimum area for reinforcement of wall. Wall material must be suitable for screw mounting.

 Area for electric and plumbing installations.

Max. load 150kg/331lb evenly distributed over the worktop up to 300cm/118in in width, according to DS/EN 12182.

## Minimum load capacity per screw/bolt:

40 kg/ 88lb

The fitter should always consider the material, condition and strength of the wall and use screws and rawplugs suitable for the specific wall type.

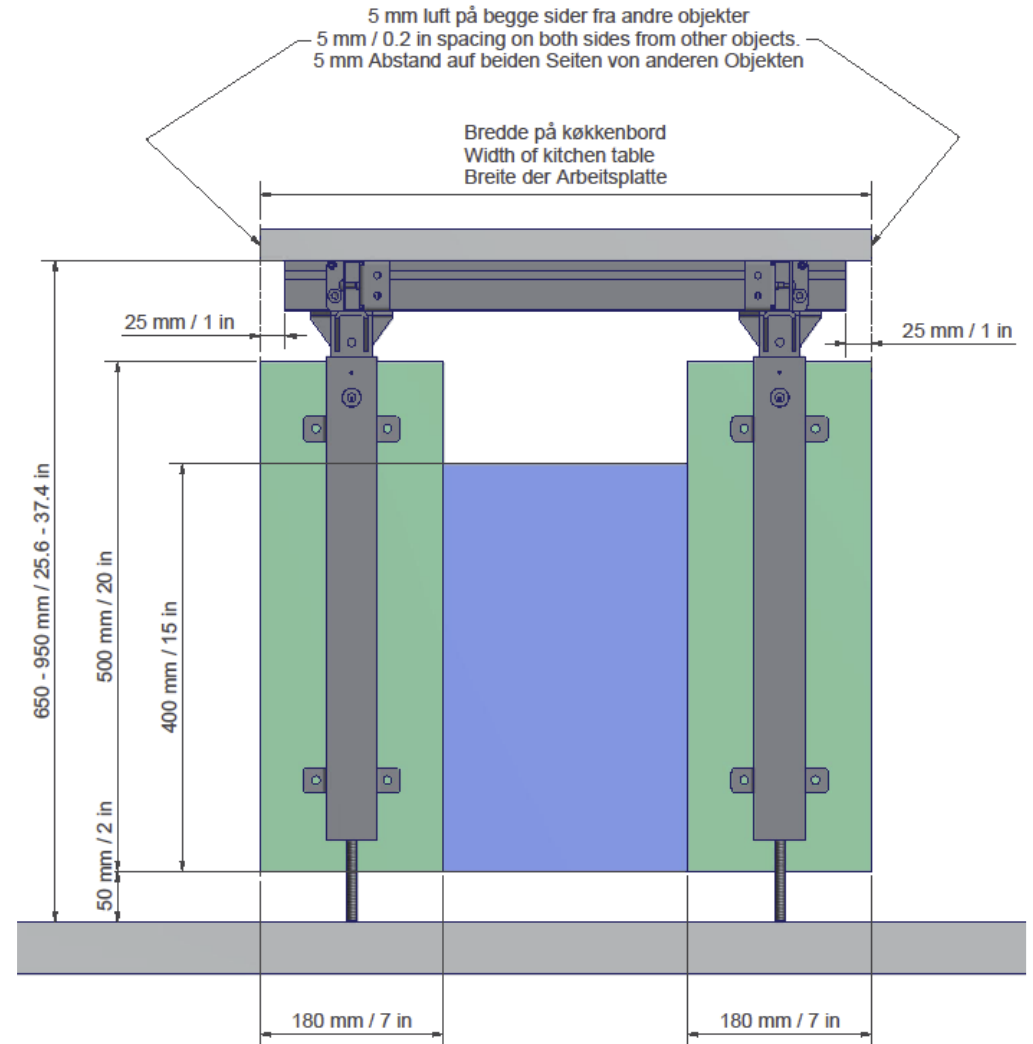

# Ropox FlexiBasic

2050 – 3000 mm / 80,7 – 118 in  
(30-63205 - 30-63300)

Construction – see dimensions on the following page

 Minimum area for reinforcement of wall. Wall material must be suitable for screw mounting.

 Area for electric and plumbing installations.

Max. load 150kg/330lb evenly distributed over the worktop up to 300cm/118in in width, according to DS/EN 12182.

Minimum load capacity per screw/bolt:  
40 kg/ 88lb

The fitter should always consider the material, condition and strength of the wall and use screws and rawplugs suitable for the specific wall type.

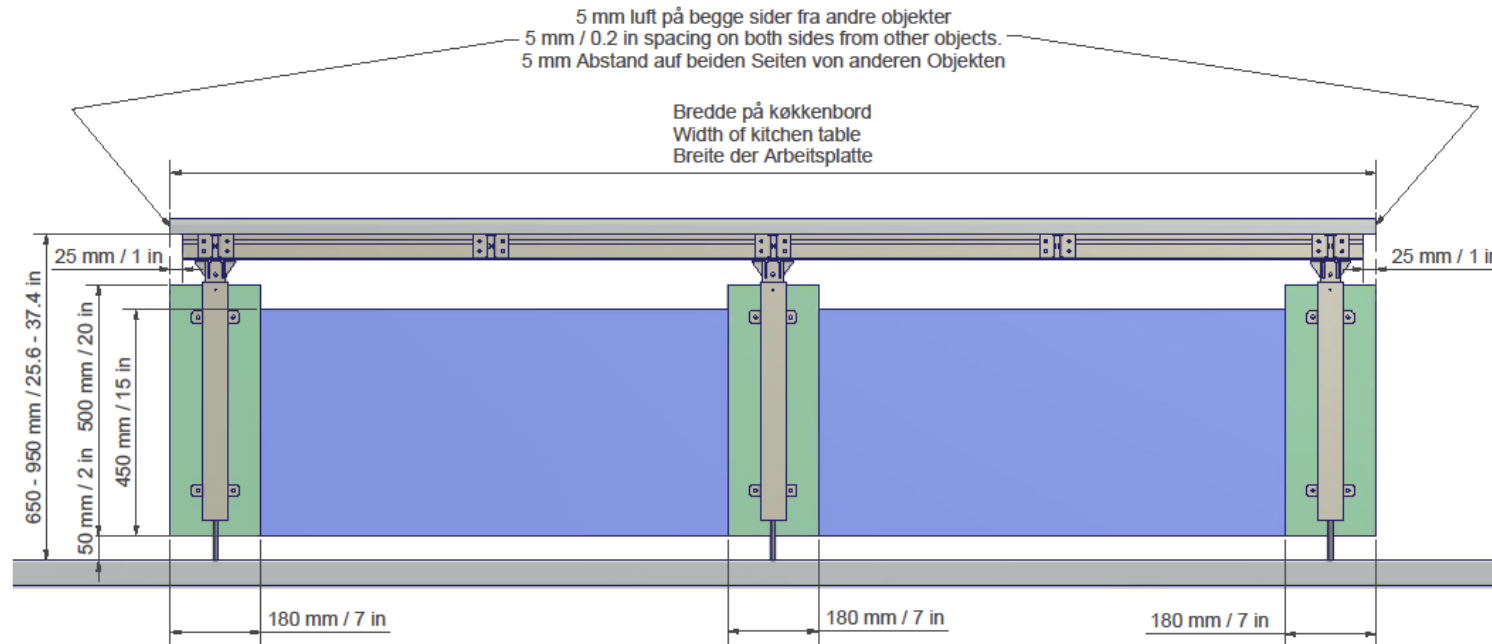

# Ropox FlexiManual

600 - 2000 mm / 23,6 – 78,7 in  
(30-65060 - 30-65200)

Construction – see dimensions on the following page

 Minimum area for reinforcement of wall. Wall material must be suitable for screw mounting.

 Area for electric and plumbing installations.

Max. load 150kg/330lb evenly distributed over the worktop up to 300cm/118in in width, according to DS/EN 12182.

## Minimum load capacity per screw/bolt:

40 kg/ 88lb

The fitter should always consider the material, condition and strength of the wall and use screws and rawplugs suitable for the specific wall type.

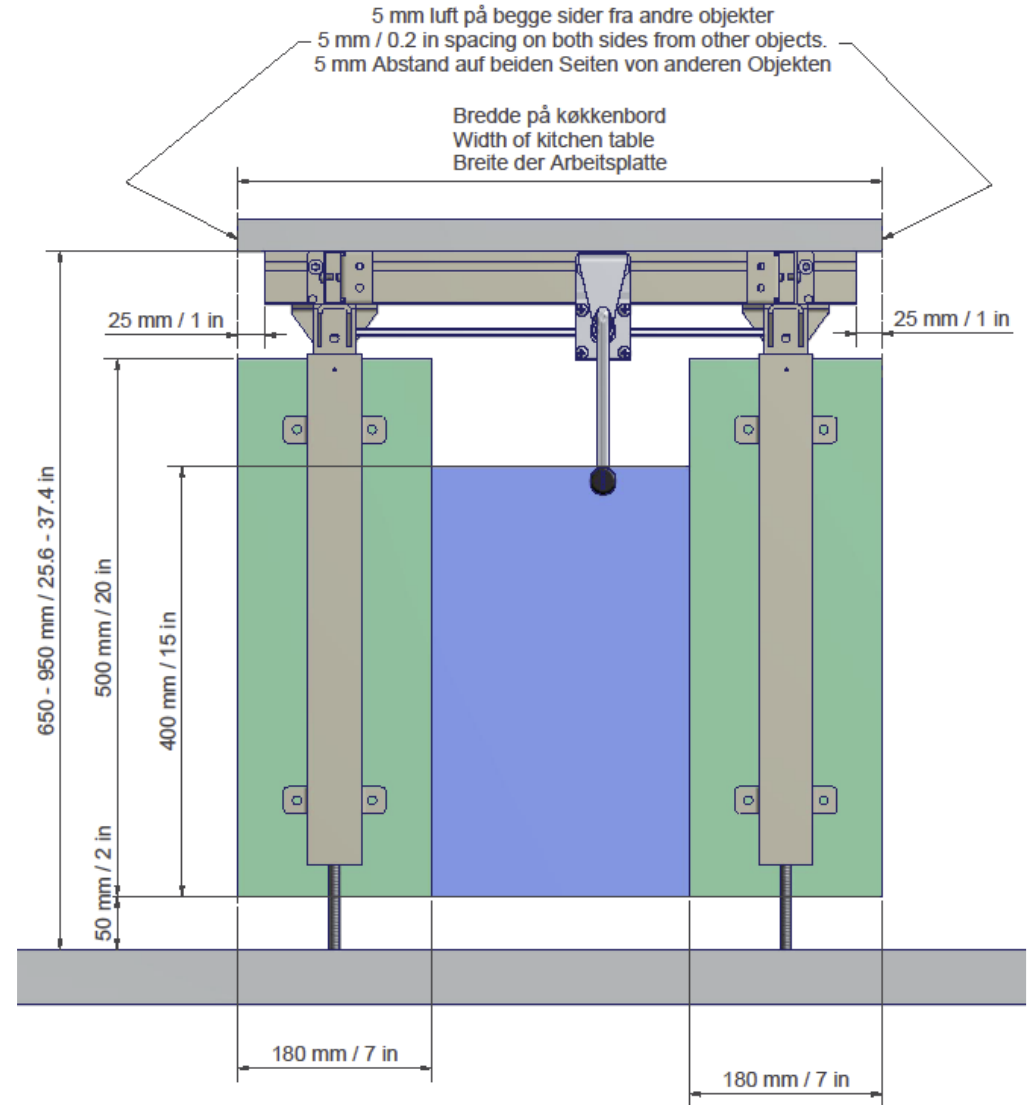

# Ropox FlexiManual

2050 – 3000 mm / 80,7 – 118 in  
(30-65205 - 30-65300)

Construction – see dimensions on the following page

 Minimum area for reinforcement of wall. Wall material must be suitable for screw mounting.

 Area for electric and plumbing installations.

Max. load 150kg/330lb evenly distributed over the worktop up to 300cm/118in in width, according to DS/EN 12182.

Minimum load capacity per screw/bolt:  
40 kg/ 88lb

The fitter should always consider the material, condition and strength of the wall and use screws and rawplugs suitable for the specific wall type.

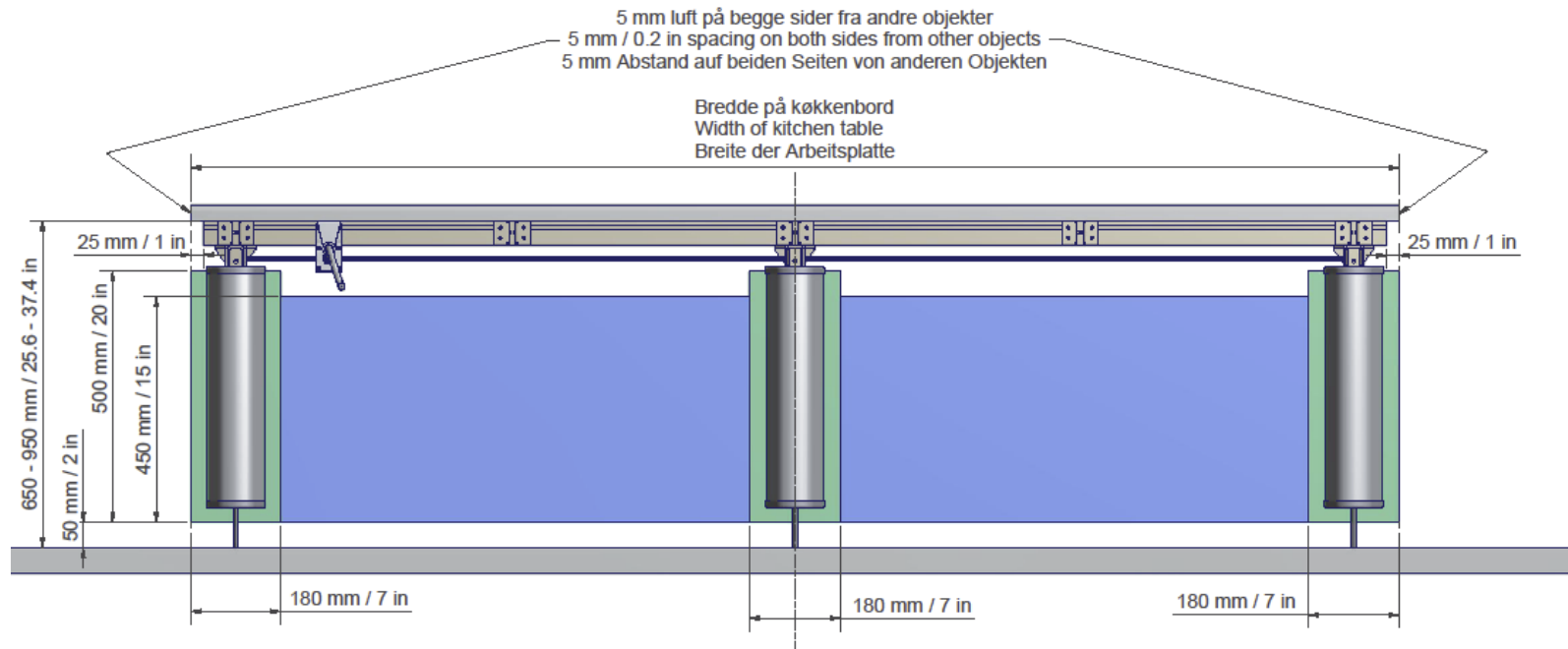

# Ropox FlexiElectric

**600 – 3000 mm / 23,6 – 118 in**  
**(30-66060 - 30-66200)**

**Construction – see dimensions on the following page**

 Minimum area for reinforcement of wall. Wall material must be suitable for screw mounting.

 Area for electric and plumbing installations.

Max. load 150kg/330lb evenly distributed over the worktop up to 300cm/118in in width, according to DS/EN 12182.

**Minimum load capacity per screw/bolt:**  
40 kg/ 88lb

The fitter should always consider the material, condition and strength of the wall and use screws and rawplugs suitable for the specific wall type.

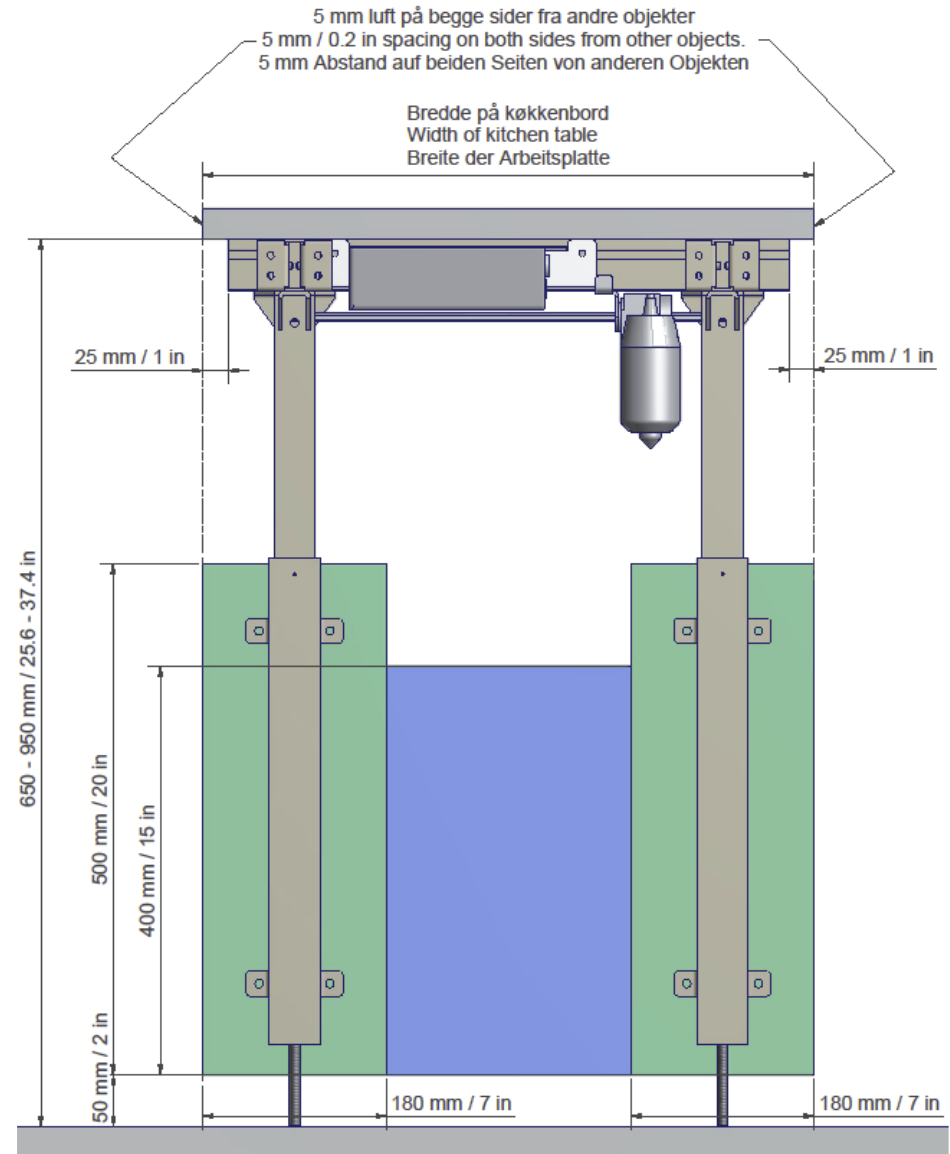

# Ropox FlexiElectric

**2050 – 3000 mm / 80,7 – 118 in**  
**(30-66205 - 30-66300)**

Max. load 150kg/330lb evenly distributed over the worktop up to 300cm/118in width, according to DS/EN 12182.

**Construction – see dimensions on the following page**

**Minimum load capacity per screw/bolt:**  
 40 kg/ 88lb

 Minimum area for reinforcement of wall. Wall material must be suitable for screw mounting.

The fitter should always consider the material, condition and strength of the wall and use screws and rawlplugs suitable for the specific wall type.

 Area for electric and plumbing installations.

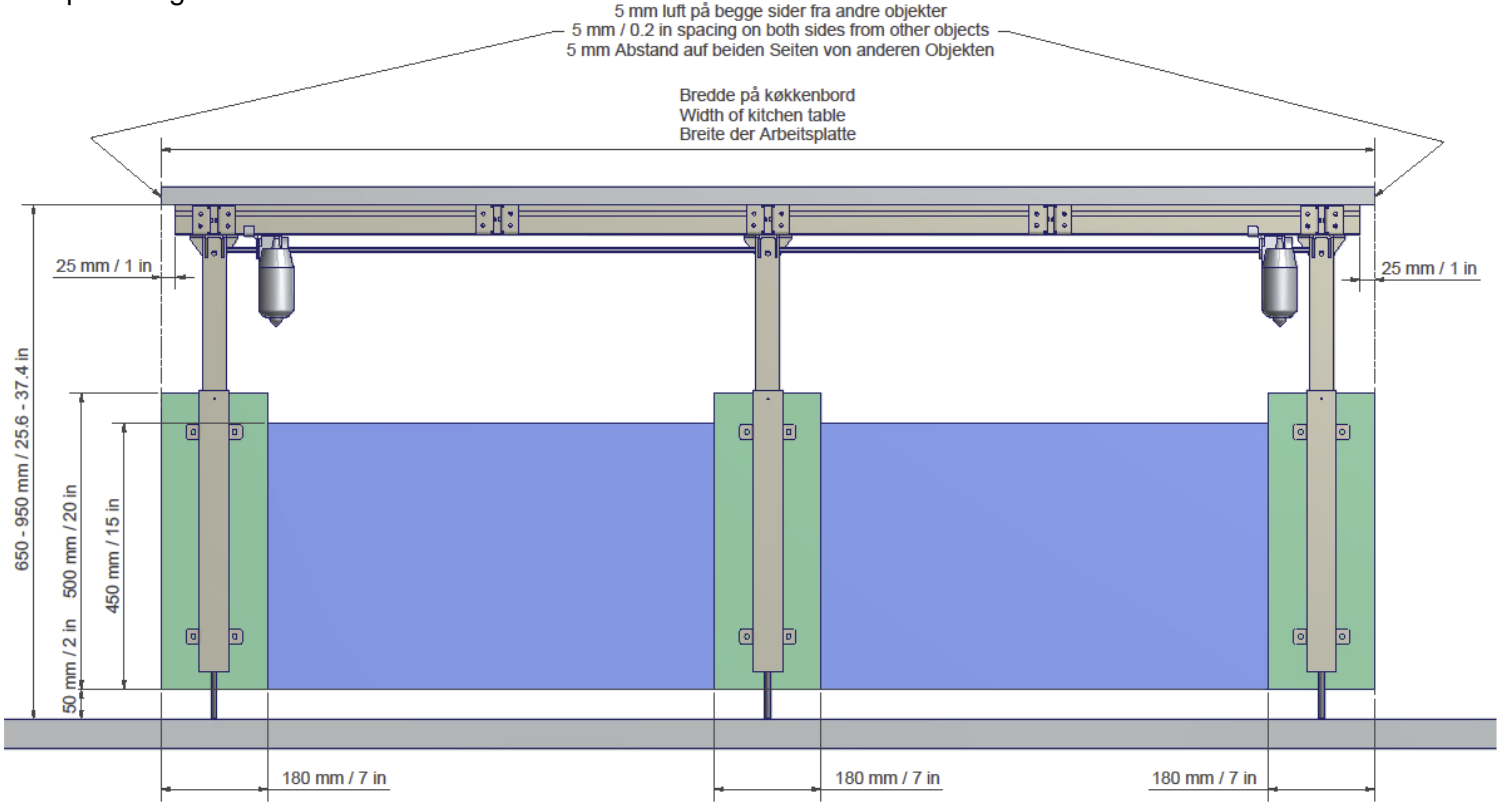

# Ropox FlexiCorner

**Construction – see dimensions on the following page**

 Minimum area for reinforcement of wall. Wall must be suitable for screw mounting.

 Area for electric and plumbing installations.

Max. load 150kg/330lb evenly distributed over the worktop up to 300cm/118in width, according to DS/EN 12182.

**Min. load capacity per screw/bolt:**  
40 kg/ 88lb

The fitter should always consider the material, condition and strength of the wall and use screws and rawlplugs suitable for the specific wall type.

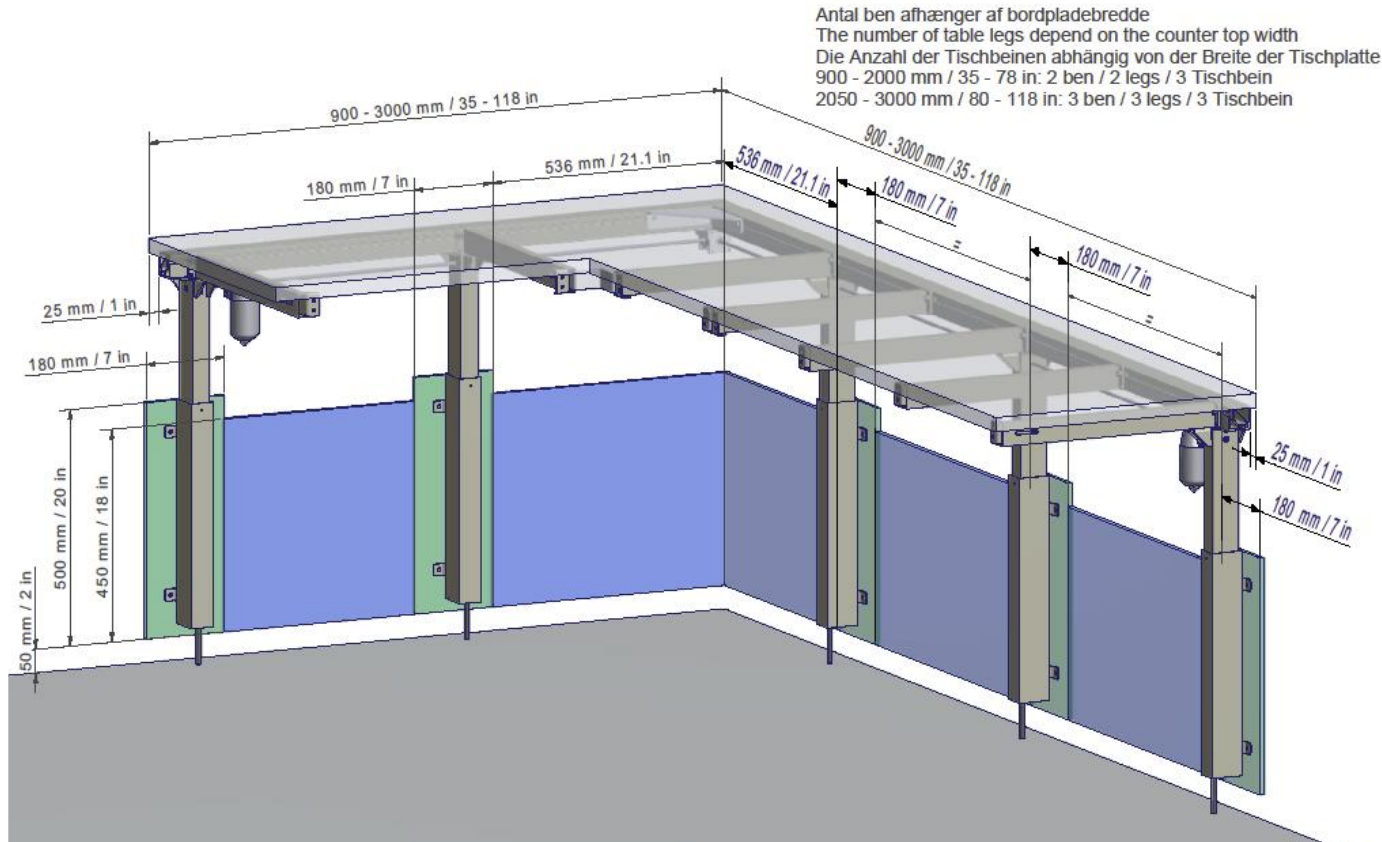





# Ropox FlexiPlus - 2 Legs

**600 – 2400 mm / 23,6 – 94,5 in**  
**(30-90060 - 30-90244)**

**Construction – see dimensions on the following page**

 Minimum area for reinforcement of wall. Wall material must be suitable for screw mounting.

 Area for electrical and plumbing installations.

Max. load 150kg/330lb evenly distributed over the worktop up to 300cm/118in in width, according to DS/EN 12182.

**Minimum load capacity per screw/bolt:**  
30 kg/ 66lb

The fitter should always consider the material, condition and strength of the wall and use screws and rawlplugs suitable for the specific wall type.

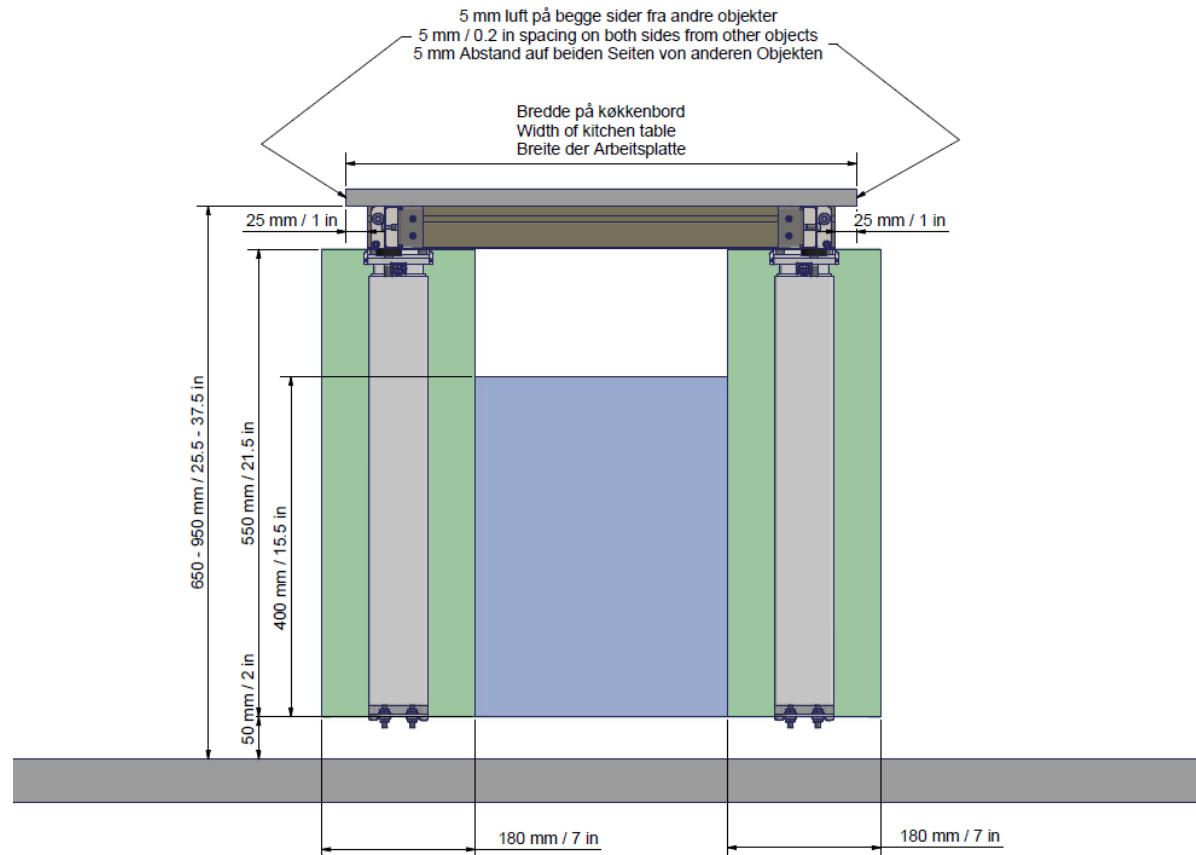

# Ropox FlexiPlus - 3 Legs

**2450 – 3000 mm / 96,5 – 118 in**  
**(30-90245 - 30-90300)**

**Construction – see dimensions on the following page**

 Minimum area for reinforcement of wall. Wall material must be suitable for screw mounting.

 Area for electrical and plumbing installations.

Max. load 150kg/330lb evenly distributed over the worktop up to 300cm/118in width, according to DS/EN 12182.

**Minimum load capacity per screw/bolt:**  
30 kg/ 66lb

The fitter should always consider the material, condition and strength of the wall and use screws and rawplugs suitable for the specific wall type.

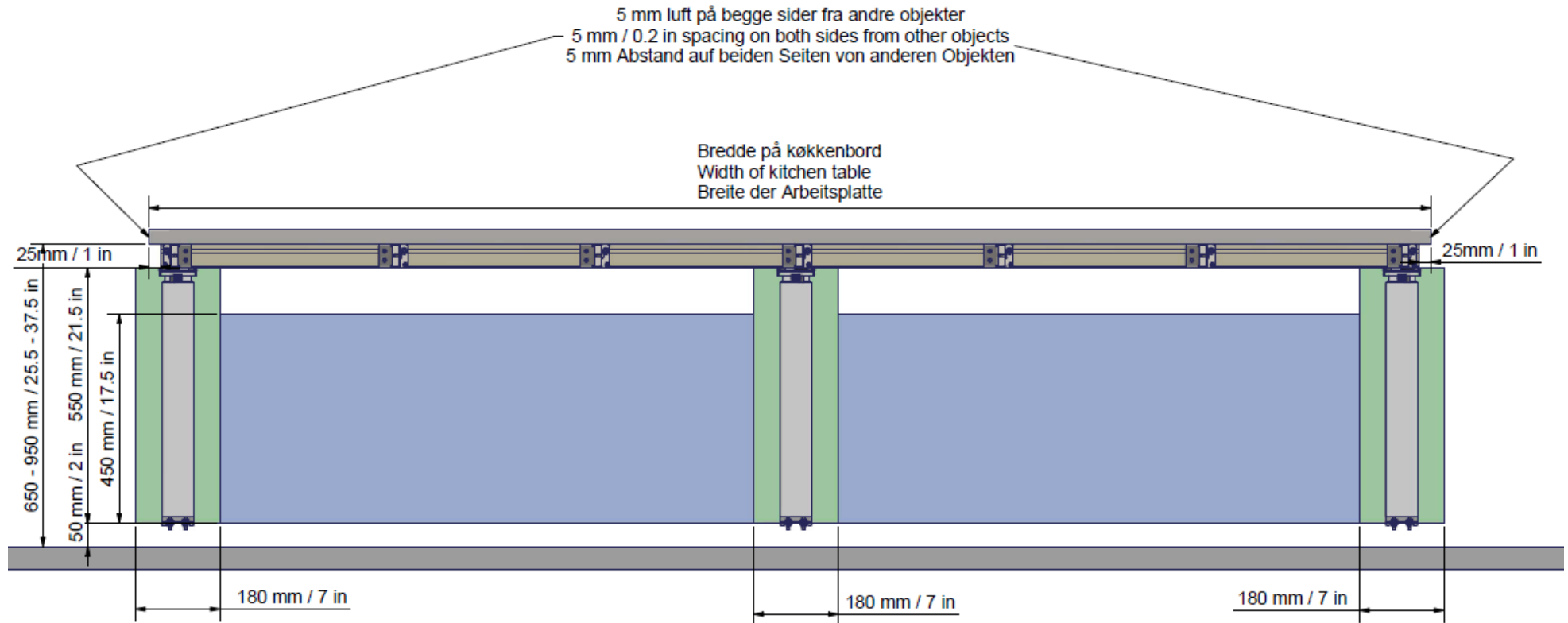

# Ropox FlexiPlusCorner

(30-91XXX-XXX)

Construction – see dimensions on the following page

 Minimum area for reinforcement of wall. Wall must be suitable for screw mounting.

 Area for electrical and plumbing installations.

Max. load 150kg/330lb evenly distributed over the worktop up to 300cm/118 in width, according to DS/EN 12182.

**Min. load capacity per screw/bolt:**  
38 kg/ 83lb

The fitter should always consider the material, condition and strength of the wall and use screws and rawplugs suitable for the specific wall type.

Antal ben afhænger af bordpladebredde  
The number of table legs depends on the counter top width  
Die Anzahl der Tischbeinen abhängig von der Breite der Tischplatte  
900 - 2000 mm / 35 - 78 in: 2 ben / 2 legs / 2 Tischbein  
2050 - 3000 mm / 80 - 118 in: 3 ben / 3 legs / 3 Tischbein

